

# USER MANUAL

## Lifestyle Classic

ED30550F



# Terry Lifts

◆ THE ONE TO TRUST ◆





# contents

---

---

<b>01</b>	INTRODUCTION
<b>02</b>	ABOUT THE LIFESTYLE CLASSIC LIFT
<b>03</b>	GENERAL DO'S AND DONT'S
<b>04</b>	LIFT CONTROLS
<b>05</b>	OPERATING THE LIFT
<b>06</b>	LIFT SAFETY SURFACES
<b>07</b>	SAFETY SURFACES CHECKS
<b>08</b>	EMERGENCY PROCEDURES
<b>14</b>	SMOKE ALARMS
<b>15</b>	FAULT FINDING
<b>18</b>	MAINTENANCE AND SERVICING
<b>19</b>	SERVICE HISTORY
<b>22</b>	LIFT SPECIFICATION
<b>23</b>	LIFT DISASSEMBLY/SAFE DISPOSAL
<b>24</b>	CE DECLARATION OF CONFORMITY

# INTRODUCTION

---



*Thank you for choosing the Lifestyle Classic lift, designed and manufactured in the U.K. using the latest technology by Terry Group Ltd.*

*We want you to get the most out of your lift and to help in this aim we have produced this booklet on operation and maintenance of the equipment, which we hope you will find helpful.*

*It is hoped that any queries you may have during day to day operation will be answered in this manual, but if you do have any problems, technical assistance is only a phone call away.*

*We hope our product gives you many years of reliable service.*

A handwritten signature in blue ink, appearing to read 'Dave Allen'.

**Dave Allen**  
Managing Director



# ABOUT THE LIFESTYLE CLASSIC LIFT



The Lifestyle Classic lift is an inter-floor lift designed for up to two standing individuals, or one seated person, travelling between fixed floor levels in private residences with a maximum carrying capacity of 250 kg.

This lift functions without a traditional lift shaft and includes an automatic infill panel, ensuring safety by securing the aperture when parked at either landing.

Emergency communication is available through a standard telephone provided within the car. Additionally, both the aperture infill and the car underpan feature half-hour fire-rated panels as a standard safety measure.

The lift car panels are constructed from powder-coated steel, offering easy cleaning using common household cleaners. Upholstery, made from high-quality contract materials, can be cleaned in the same manner.

# GENERAL DO'S AND DONT'S

---

Below are the key safety measures for lift operation to ensure safe usage and prevent potential hazards.

- **Never** switch off the power supply to the lift, even when you go away. The lift control circuits are fed by a battery, which must be kept on constant charge.
- **The lift should always** be returned to the lower level when not in use. If it is left upstairs for prolonged periods, it will occasionally re-level itself depending on conditions. The lift must be left at the lower level if the mains is turned off.
- **Keep hold of the door** whether opening or closing.
- **Always close the door** after using the lift.
- **Never** allow children to play in, under or around the lift.
- **Ensure** the area under the lift is kept clear. The underpan surface is fitted with sensors, which automatically stop the lift if it strikes an object (see Page 06).
- **Always** keep the key fob, if supplied and emergency release key in a safe place near the lift. The in-car release keys in the lock bar unit should not be removed unless there is an emergency.
- **Do not** place any object on the aperture infill or stand on it when the lift is in operation. Ensure that as far as practical, the area around the travelling infill panel is clear of persons (particularly children) when the lift is being operated. The infill panel is fitted with sensors that automatically stop the lift if the infill panel is obstructed (see Page 06).
- **Only** use the lift for transporting up to two people standing, or one seated, between fixed floor levels.
- **Always** treat your lift with the respect that should be shown to electrical and mechanical equipment.
- Safety related components **should only** be adjusted and reset by a competent person.
- **Do be aware** some lift systems generate varying magnetic fields. Pacemaker users should seek expert guidance before using it to ensure safety.

# LIFT CONTROLS



## Car light intensity control

On one of the call stations, by pressing and holding the 'stop' and 'down' buttons, the light intensity will reduce. By pressing and holding the stop and up buttons, the light intensity will increase. When the desired level is reached, release the buttons.



## Car light timer

To vary the length of time the car light stays on after operating the lift, press and hold the 'stop', 'up' and 'door' buttons, the light timer will then sequence through the light-on times and respond with a series of beeps. Each beep represents five minutes in time. When the desired time is reached release the buttons.



## Call stations

The call stations and the optional remote control fob are fully integrated units with internal batteries. The batteries can be changed by the user with a Philips screwdriver on the back of each unit.

CR2450 (550 mAh minimum) are approved for use with these device.



## Optional remote isolate fob

The lift can be isolated by using the optional remote control fob. When the lift is isolated none of the control stations will function.

The call and control stations can only be activated by using the remote fob. When the lift is activated, the coloured indicator lights in the car will illuminate.

The lights in the car will switch on automatically when any call or control button is pressed and will automatically turn off after the pre-set time. (See 'Car light timer' above).

# OPERATING THE LIFT

There are two wall mounted call stations, one at each level and a similar control station fitted in the lift car. The call stations connect to the lift via Bluetooth technology.

## General operation

Call the lift by pressing the 'UP' or 'DOWN' button on either call station and wait for it to stop. The door will unlock and can then be manually opened. Press and release 'UP' or 'DOWN' button on the control station for the lift to travel uninterrupted to the next floor.

If the lift does not start, check that the door is properly closed and try again.

Always close the door after using the lift, and leave the lift downstairs whenever possible.

## Changing batteries

It is critical that all three batteries are replaced with NEW ones of the same type, manufacture and age, that they are fitted at the same time and that they are correctly oriented.

Slide the unit off the wall bracket and remove the four screws in the back with a posi-drive screwdriver. Using a screw driver, gently push the batteries out a short way, and then pull using fingers.

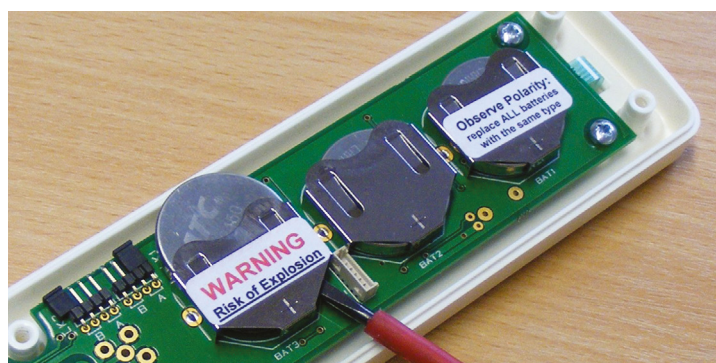
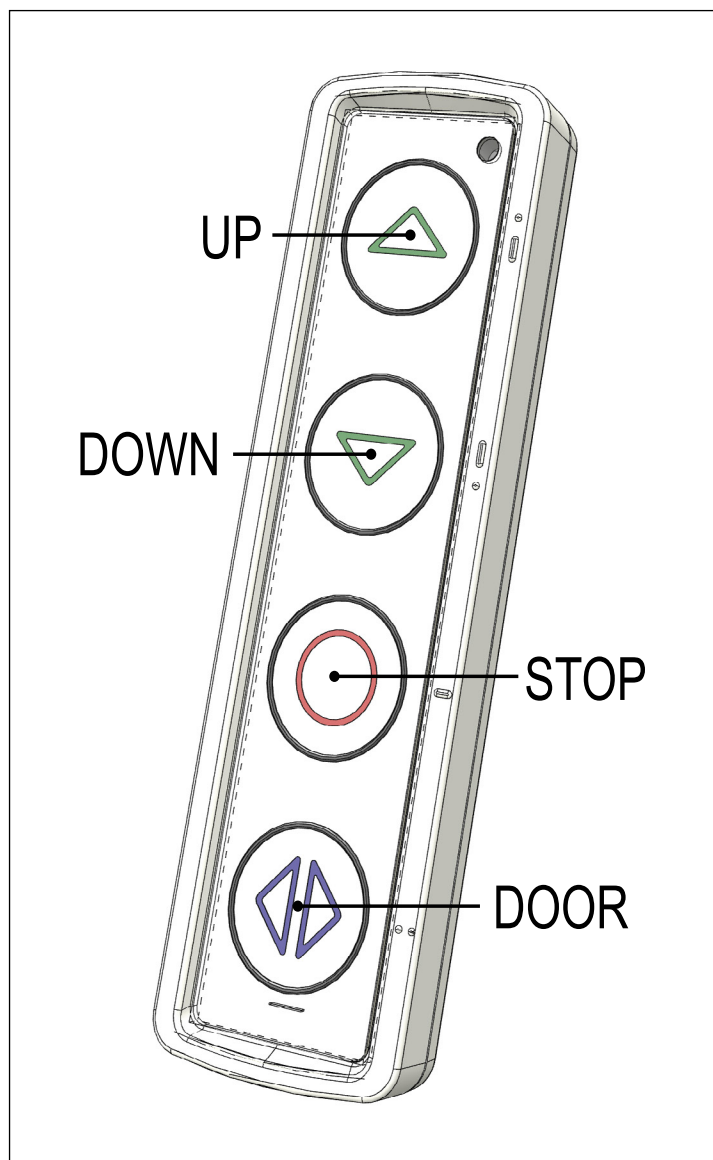



# LIFT SAFETY SURFACES

The diagrams below illustrate the positions of the sensors on the lift which are designed to prevent injury or damage in case the carriage's movement is obstructed. Any downwards or upwards pressure on the surfaces highlighted will prevent the lift from operating.

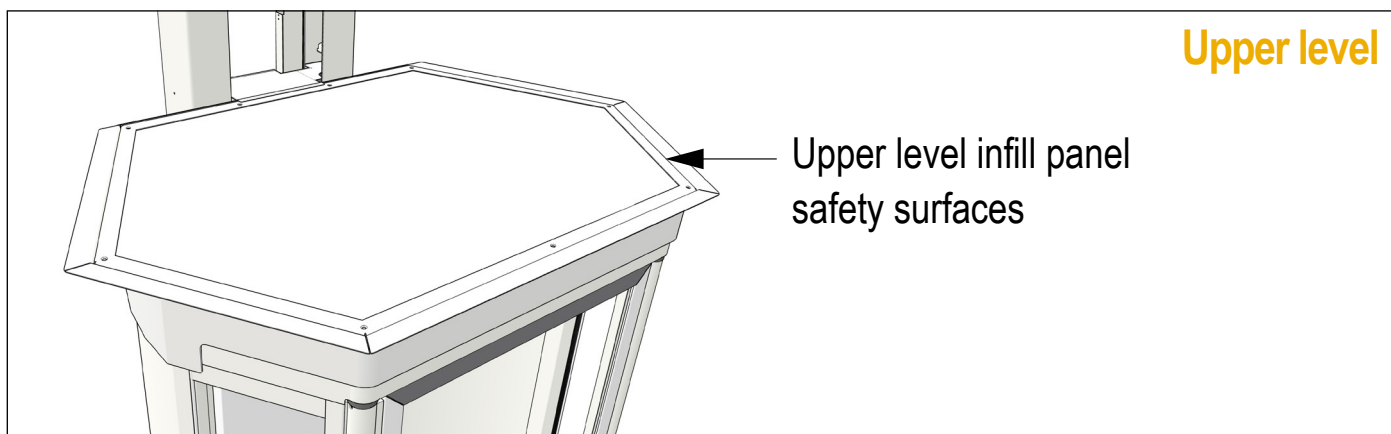
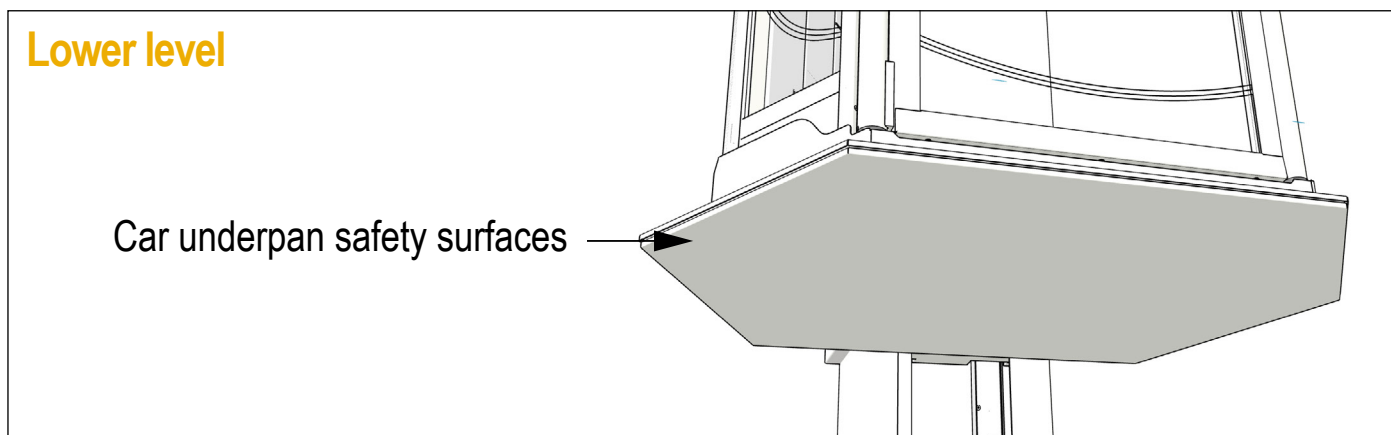
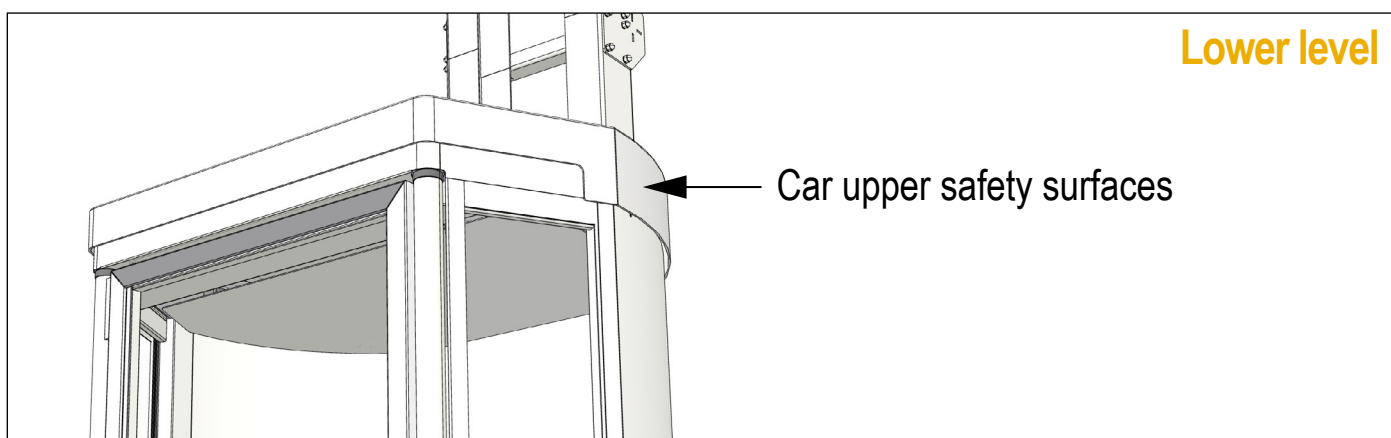

# SAFETY SURFACE CHECKS

---

As a precautionary measure we advise the following periodic (weekly) checks of the safety features built into your Lifestyle Classic lift. These checks should be carried out with the lift unoccupied.

## Car upper safety surfaces

With the lift at lower level, press the 'UP' button on the wall station, when lift starts to ascend press downwards on the car upper safe edge, the lift should stop. Repeat operation on opposite side of lift.

## Car underpan safety surfaces

With the lift at approximately eye level press the 'DOWN' button on wall station, when lift starts to descend press upwards on the carriage underpan, the lift should stop. Repeat operation on opposite side of lift.

## Upper level infill panel safety surfaces

From the upper level, call the lift by pressing the 'UP' button, when lift starts to ascend through the aperture, press downwards on the infill panel safe edge, the lift should stop. Repeat operation on opposite side of lift.

## Door handle safety surfaces

With the lift at lower level, press the 'UP' button on the wall station, when lift starts to ascend press the door handle in, the lift should stop.



**If any of the above checks fail, the lift must not be used and advice sought from Terry Group Ltd on 01565 752 800.**

# EMERGENCY PROCEDURES

---

## Emergency lowering

In the event of a mains failure during travel, the battery backed control system of the lift will allow normal operation in the down direction without loss of any safety features. This allows the user to exit the car at the lower level in the normal way.

If the lift has stopped mid-travel and does not respond to pressing the 'UP' or 'DOWN' buttons, then the lift can be manually lowered by one of following methods:

- Lowering the lift from inside the lift car see Page 09.
- Lowering the lift from outside the lift car see Page 10.

### **Important**

- During emergency manual lowering, the normal safety features will not function, so the lift will not stop if a person, pet or object is under the lift.
- The exact lowering procedure must be observed in each case, because the normal safety features will not function during manual lowering.
- The emergency lowering procedures should never be used if the lift is fully up or no one is trapped in it.
- The emergency lowering procedures should also never be used as the normal down travel function until an engineer attends.

# EMERGENCY PROCEDURES

## Lowering the lift from **inside** the lift car

### First

If other people in the house, they must be alerted to the fact that the lift has stopped. They should assist in the lowering procedure by ensuring the following:

- That no object, person or pet are in the path of the lift travel.
- That the aperture infill panel follows the lift during descent and locates fully in the upstairs floor to guard against anyone falling into the lift-way.

If no other people are in the house, check as best you can that no pets or obstacles are in the path of the lift travel.

### Then

Locate the emergency lowering key in the lock bar by pulling the cover towards you and follow the steps below.

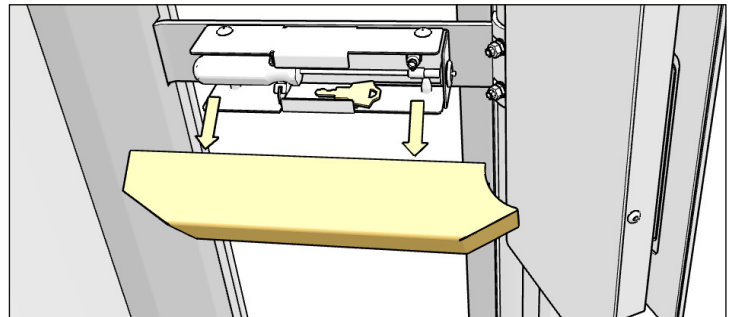

1. Insert the emergency lowering key into the rear control panel.
2. Turn the key clockwise and hold it there with one hand.
3. Simultaneously, with the other hand, press and hold the 'DOWN' button to lower the lift.
4. If the door lock does not release automatically when the lift is down, press the 'DOOR' button on the control station. If this does not work, see Emergency Unlocking (Page 11).

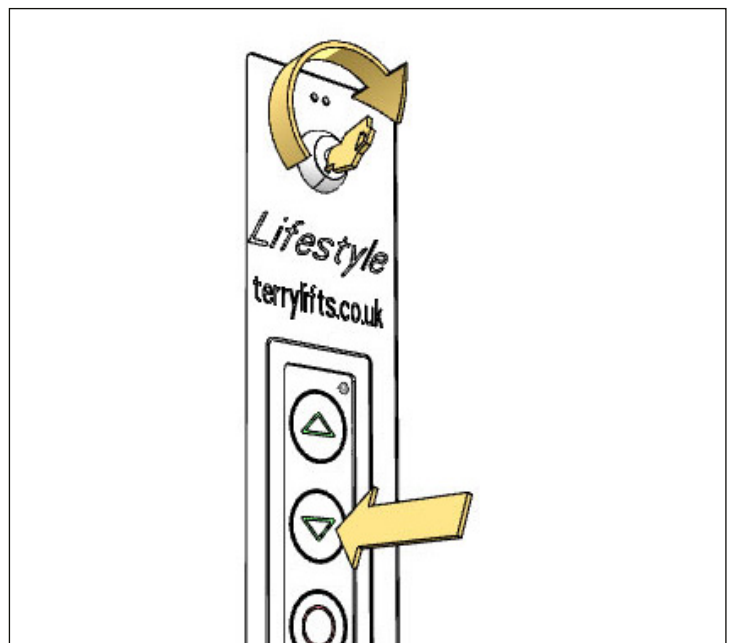



# EMERGENCY PROCEDURES

## Lowering the lift from **outside** the lift car

If the lift has stopped mid level and the customer is unable to get the lift up or down, then the only time it should be lowered by the emergency valve is if:

- There is a 2nd person around the lift area at the lower level to ensure that nothing goes under the lift during the lowering by the first person.
- OR the person lowering the lift has sight of the area under the lift.

### Person 'A'

- Ensure the lift door is fully closed.
- Turn off the mains supply to the lift.
- Locate the hydraulic power unit (normally outside the property). Using the Torx driver supplied, swivel the small metal cover plate on the front face of the housing.
- The red cord revealed in the access hole now needs to be pulled continuously to lower the lift car slowly.
- After 5 seconds release the cord and check with **Person 'B'** that the aperture infill panel is following the carriage. If so, resume pulling the cord as before.
- Once the lift is at the lower level, turn the mains supply back on and secure the metal cover plate.

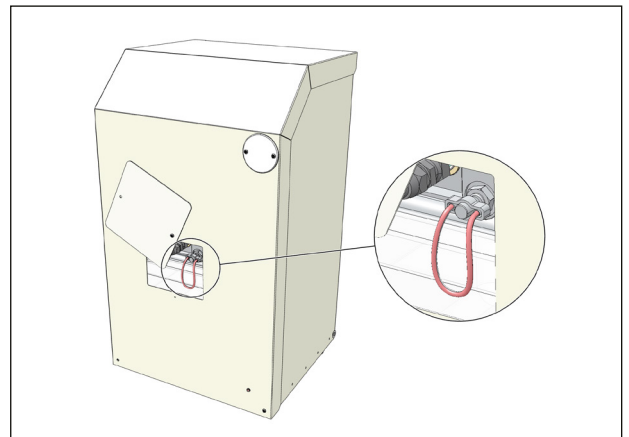

### Person 'B'

- Remain in the house by the lift and communicate with **Person 'A'** to ensure the safe lowering of the lift.
- Ensure that no object, person or pet are in the path of the lift travel.
- Confirm that the aperture infill panel follows the lift during descent and locates fully in the floor to guard against the possibility of anyone falling down the lift way.

# EMERGENCY PROCEDURES

---

## Emergency door release

When the door lock has been manually over-ridden in an emergency, an engineer will need to be called to check the lift and to reset the lock. The lock cannot be reset by the customer.

The lift car door is designed so that it will only unlock when the lift is within 25 mm of each floor served. If for any reason the lock does not function, it can be over-ridden by one of the following methods:

- To release the lock from inside the car see Page 12.
- To release the lock from outside the car see Page 13.



### Important

- **The door lock may only be manually over-ridden from inside the lift car if:**
  - The lock has failed and does not respond to operation using the normal controls.
  - The lift is stationary at the upper or lower landing.

# EMERGENCY PROCEDURES

## Emergency release from **inside** the car

Within the lock bar unit, there is an emergency release tool to enable the lock to be over-ridden.

Pull the lock bar cover forward to access the tool.

Then, remove the two hole covers to gain access to the lock mechanism.

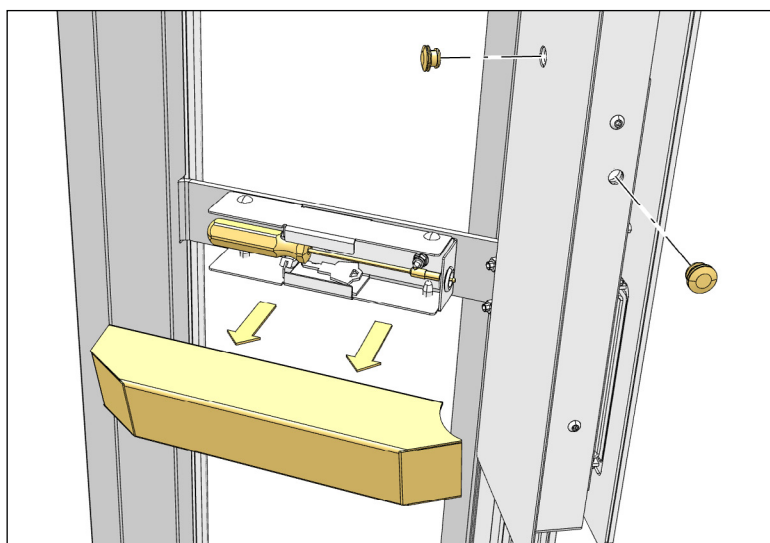

Insert the tool and engage the tip of the tool in the socket inside the lock box. Rotate the tool a quarter of a turn (clockwise or anti-clockwise) - a click can be heard.

The lock drive unit is now disengaged. Remove the tool.

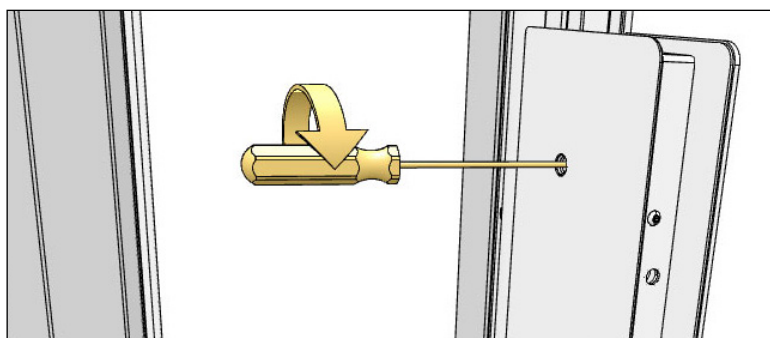

Screw the tool into the end of the lock bolt (clockwise).

Then pull the tool away from the lock box pulling the lock bolt out to the unlocked position.

The door will now open.

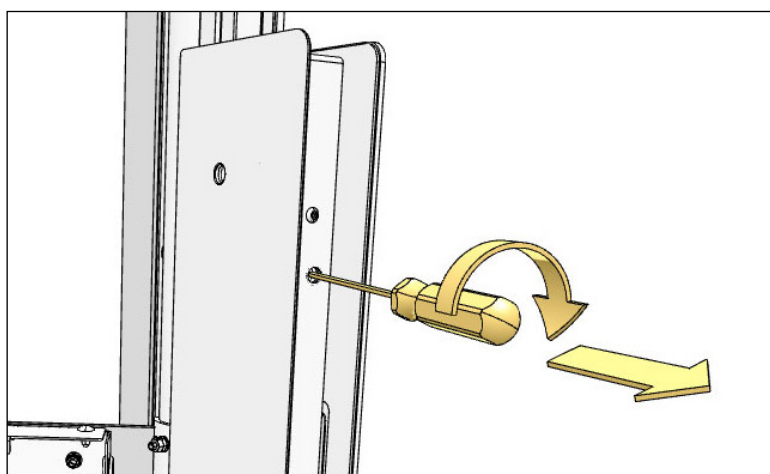

# EMERGENCY PROCEDURES

## Emergency release from **outside** the car

Locate the emergency release tool attached with a magnet to the side or the back of the guide (as agreed with the client).

Remove the hole cover to gain access to the lock mechanism.

Insert the tool and engage the tip of the tool in the socket.

Rotate the tool a quarter of a turn (clockwise or anti-clockwise) - a click can be heard.

The lock drive unit is now disengaged. Remove the tool.

Remove the hole cover from the round upright tube at the point where the lock operates.

Insert the tool in the hole until it engages with the end of the lock bolt. A firm push will then release the lock.

The door will now open.

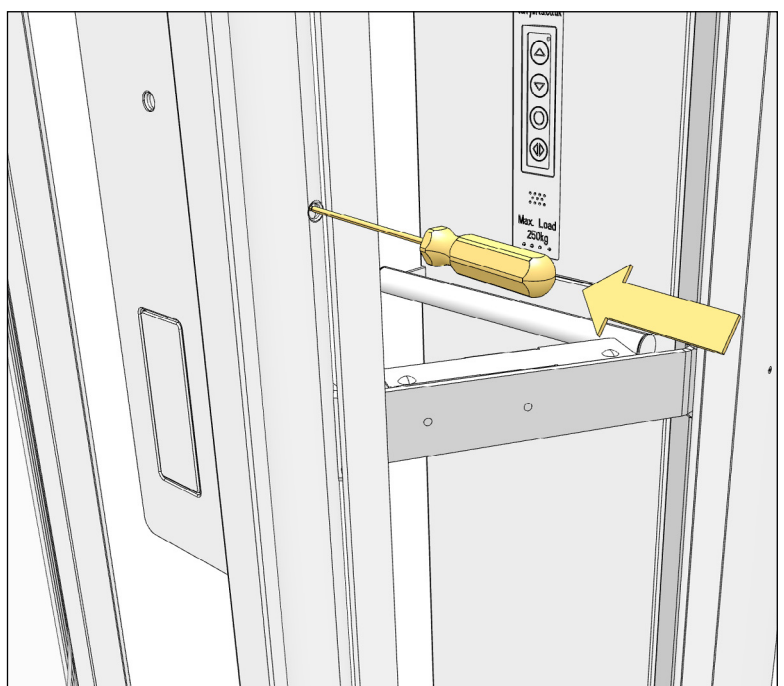



# SMOKE ALARMS

---

A smoke detection system has been installed on your lift. It has been designed to provide adherence to **British Standard BS5900 2012 Section 9.13 'Behaviour of homelift in the event of fire'**.

The system utilises two smoke alarms, one upper level, one lower level, which are wirelessly connected to the main circuit board on the lift.

The smoke alarms contain an integral battery with a 10 year life-span. This is not replaceable.

## Radio smoke alarm operation

When installed on a Lifestyle Classic lift, the smoke alarm system will cause the lift to deactivate safely once the alarm is triggered. When the lift is deactivated, the door will continue to operate as normal.

## When the lift is stationary at either level

If smoke is detected, the alarm will sound. After a period of time, all other smoke alarms connected to the system will then start to sound and the lift deactivates.

## When the lift is travelling between levels

If smoke is detected, the alarm will sound. After a period of time, all other smoke alarms connected to the system will then start to sound.

The lift will continue to its requested level, it will remain possible (until that level is reached) to change the direction of the lift.

Once at the desired level, the lift will deactivate.

## Reactivation of lift

The lift will automatically reactivate when the smoke alarm no longer detects smoke and a period of two minutes has expired.

## Silencing the smoke alarms

The alarms can be silenced by pressing the mute button on the sensor that initiated the alarm. The initiating sensor can be identified by a Red light flashing every second. When the alarms are deactivated, the lift will automatically reactivate when a period of two minutes has expired. If the source of the smoke alarm is not removed, the smoke alarms will begin to sound again and the lift will be disabled.

# FAULT FINDING

The most likely causes of your lift failing to operate are the door not being fully closed, lack of mains power supply, or something obstructing the car's travel. To assist in identifying the cause, the car is fitted with a simple system of coloured LED indicator lights on the rear panel.

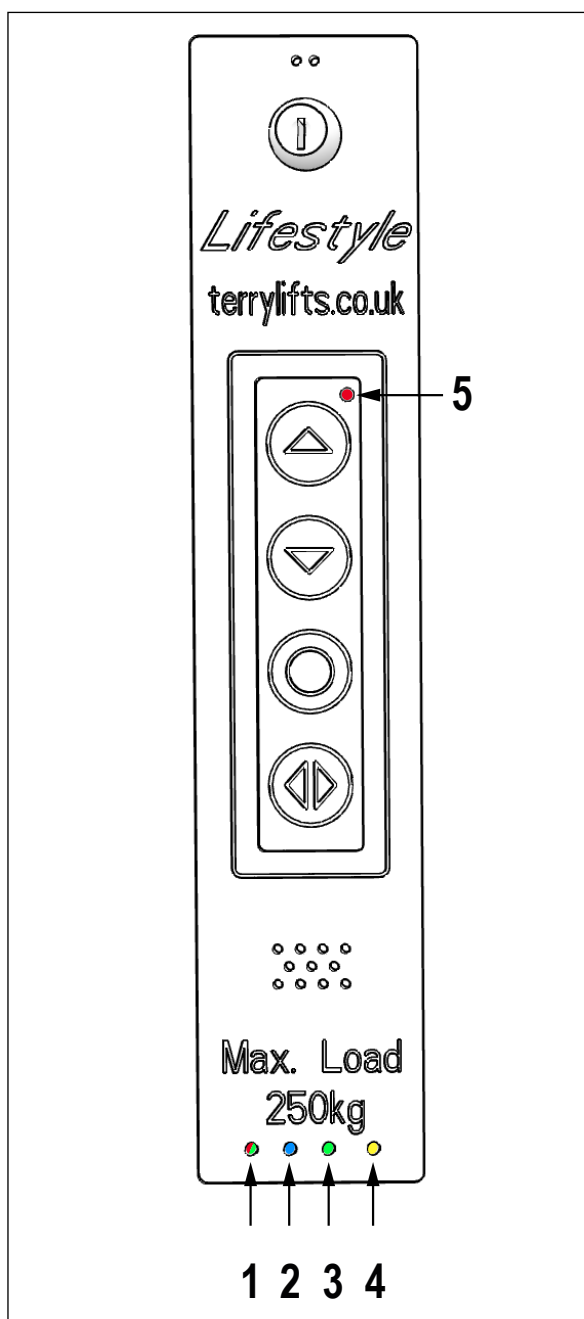

## Along the bottom from left to right

1. Red/Green light - Normally off. Indicates optional GSM unit operation.
2. Blue light - Comes on when door fully closed and locked (when lift has been activated with optional fob).
3. Green light - Indicates that upper car safe edge is ok. Will be off when car descends
4. Yellow light - Indicates that lower car safe edge is ok. Will be off when car ascends.

## And above the 'UP' button

5. Red light - Normally on. Will be off if power pack emergency circuit is broken.

# FAULT FINDING

## Lift malfunction

Fault	Indication	Cause	Remedy
No lift function at all	Red light on powerpack cover off.	No power to lift.	Check mains is on and reset RCD at main board if required.
No lift function at all	Red light off.	Power pack emergency circuit broken.	Call a suitably trained engineer.
Car will not travel in either direction	No blue light on car panel.	Door not shut or remote fob off. Car top safe edge obstruction. Door handle stuck in.	Press the door button Press the button on fob.
Car will not go up	Green off on car panel.	Car safe edge obstruction.	Remove obstruction or free safe edge.
Car will not go down	Yellow off on car panel.	Car underpan obstruction.	Remove obstruction from beneath surface.

## Handset malfunction

Indication	Cause	Remedy
Single short beep on lift car every 2 minutes	Low Handset battery	Replace all 3 CR2450 batteries in handset

# FAULT FINDING

## Smoke alarm malfunction

Indication	Cause	Remedy
Smoke alarm green light flashes once every minute.	System functioning correctly. (Quiescent mode)	No action necessary.
Smoke alarm sounds 3 beeps approximately every 4 seconds with flashing red light repeating.	Smoke alarm has been activated.	Your homelift is interlinked to this alarm signal and will terminate at next landing level if in use. If parked will not operate until two minutes after alarm signal has stopped.
Smoke alarm beeps once every minute accompanied with a single flash of the red light.	Battery low.	Call engineer. Do not ignore the low battery alarm. If you have called engineer and the beep is a nuisance, press test button to silence the low battery alarm for 10 hours.
Smoke alarm beeps once every 10 seconds.	Unit malfunction.	Call engineer.
Smoke alarm will not sound when test button pressed.	Unit malfunction.	Call engineer.
Smoke alarm test button light either constantly illuminated or constantly off.	Unit malfunction.	Call engineer.



# MAINTENANCE AND SERVICING

---

Provided the operating instructions are observed the lift will give many years of trouble free service. Dependent on frequency of use, this lift should be serviced at least every 12 months. This service should be conducted by competent persons trained in servicing and repair of the product. Terry Group Ltd. can quote for servicing on request.

 **Note:** Servicing should only be conducted by an approved service engineer.

If in any doubt about the operation of the lift please contact the installation company for advice.











# LIFT SPECIFICATION

Name and address of manufacturer	Terry Group Ltd. Unit 1 Longridge Trading Estate, Knutsford, Cheshire, England WA16 8PR
Lift serial No.	
Year of manufacture	
Safe working load	250 kg
Maximum travel	4.3 metres
Duty cycle	10 cycles per hour with max load
Average noise level	65 Dba
Power supply	Dedicated 240V ~ 50/60 Hz single phase supply
Control voltage	12V DC
Hydraulic pump power consumption	750W maximum
Hydraulic oil grade	T22
Design standards	BS5900:2012 and 2006/42/EC Machinery Directive
Fire specification	Half hour fire integrity through aperture, assessed by Warrington Fire Research Centre.

## Terry Lifts

Our policy is one of continuous product development and the Company reserves the right to change specification without notice.

# LIFT DISASSEMBLY/SAFE DISPOSAL

---

This lift must be disassembled by a competent person who has been fully trained in the installation of this lift and is qualified to provide safe disconnection of the lift to the mains terminal.

## Batteries & Printed Circuit Boards (PCB)

The batteries and PCB's within this product should not be disposed of with other household waste at the end of their working life. Where batteries are marked with the chemical symbols Hg, Cd or Pb, it indicates that the battery contains mercury, cadmium or lead above the reference levels in EC Directive 2006/66. If batteries are not properly disposed of, these substances can cause harm to human health or the environment.

Batteries and PCB's that are no longer required for this lift, at the end of their working life, can be returned either to an approved waste disposal facility or to Terry Group Ltd for safe disposal.

## Oil

Oil from this lift should be disposed of via an authorised waste disposal contractor, to an approved waste disposal facility.

# Terry Lifts

## Declaration of Conformity



Machinery Description: LIFESTYLE LIFT / SALISE LIFT

This lift was manufactured by Terry Group Ltd., who declare that this lift fulfils all the relevant provisions of the following Directives:

2014/30/EU	Electromagnetic Compatibility Directive
2006/42/EC	Machinery Directive

This lift also fulfils all the relevant provisions of the following Standards:

BSEN 12015:2014	Electromagnetic compatibility. Product family standard for lifts, escalators and moving walks. Emission.
BSEN 12016:2013	Electromagnetic compatibility. Product family standard for lifts, escalators and moving walks. Immunity.
BS 5900:2012	Powered homelifts with partially enclosed carriers and no liftway enclosures – Specification

This Declaration of Conformity covers all Lifestyle and Salise lifts manufactured since Jan 2021 with a serial number starting L.

Person authorised to compile Technical File: Peter Morrey, Terry Group Ltd., Longridge Trading Est, Knutsford, Cheshire, WA16 8PR.

EC examination carried out by: Bureau Veritas, 8, cours du Triangle 92800 Puteaux, Paris, France.

Approved Body Reference Number: 2681

EC examination certificate number: 2681/5589/760/10/21/0264

This declaration was completed at Terry Group Ltd., Longridge Trading Estate, Knutsford, Cheshire, WA16 8PR in November 2021

This compliance is only valid if the installation test Certificate has been completed and signed by a competent lift engineer trained to install this product to the latest installation instructions.

TERRY GROUP Ltd.

A handwritten signature in black ink, appearing to be 'D.C. Allen', written over a horizontal line.

D.C. Allen  
Managing Director











# Terry Lifts

**Terry Group Ltd.**

1 Longridge Trading Estate  
Knutsford, Cheshire, WA16 8PR

01565 752 800

[sales@terrylifts.co.uk](mailto:sales@terrylifts.co.uk)

[www.terrylifts.co.uk](http://www.terrylifts.co.uk)



Proudly Designed and Manufactured in Britain